

# Campbelltown campus

The Campbelltown campus shuttle bus will operate a loop service between Campbelltown station, Campbelltown Hospital, Macarthur Square and Campbelltown campus from Monday 4th January 2011 to Friday 23rd December 2011. Buses depart from stops approximately every 30 minutes. During teaching periods hours of operation are 7.00am - 10.00pm, during exam periods 8.00am - 7.30pm and during semester breaks a reduced service is provided between the hours of 7.30am and 6.30pm Mon - Fri. This is a free service for UWS students and staff. Feedback/suggestions can be emailed to [transportaccess@uws.edu.au](mailto:transportaccess@uws.edu.au)

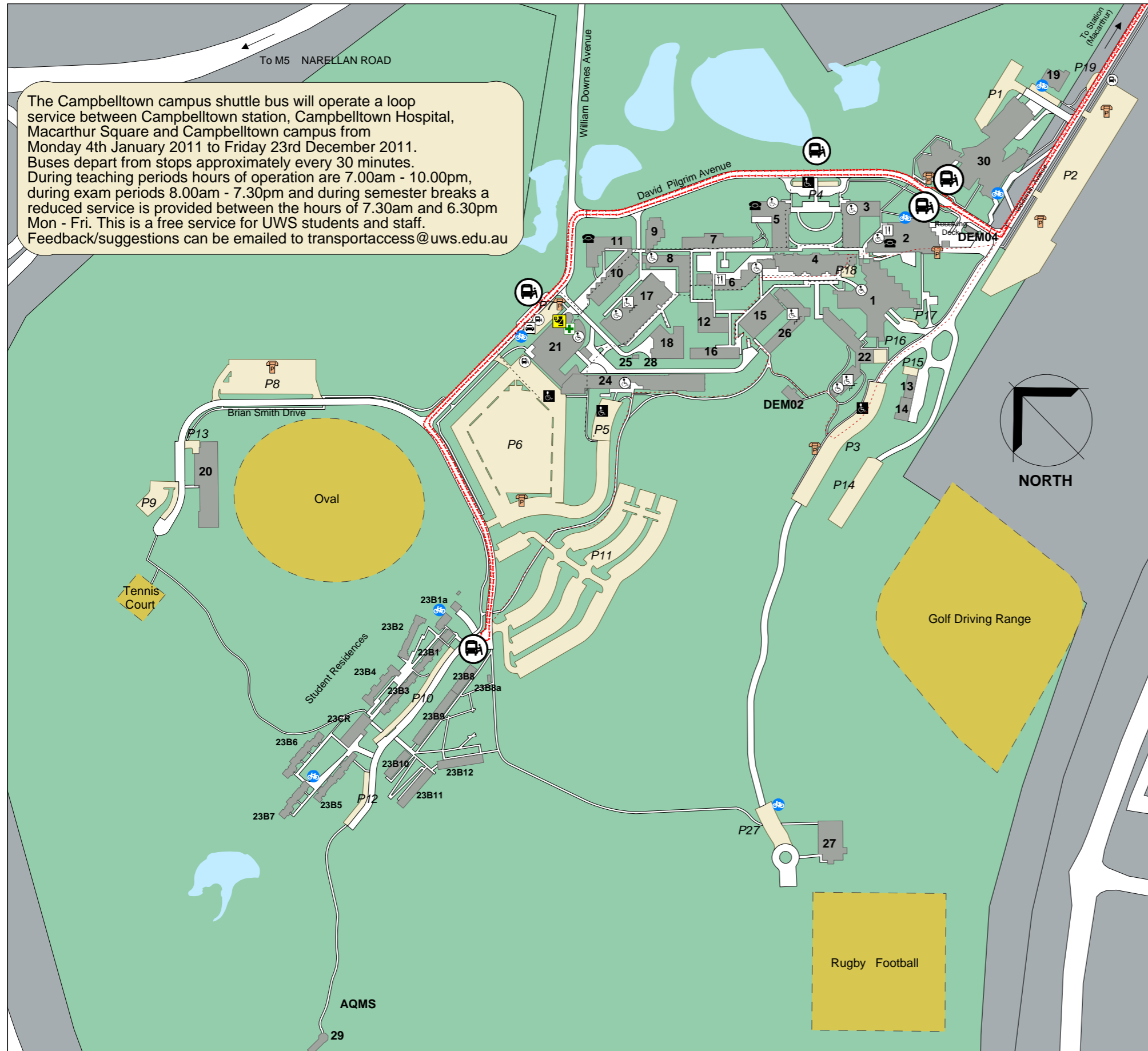

## Campbelltown campus

- Building 1**  
 Connect Books  
 Library
- Building 2**  
 Cafeteria, Coffee Shop & Retail Outlet  
 Multi Faith Centre  
 - Chaplaincy  
 - Muslim Prayer Room  
 St John's Ambulance
- Building 3**  
 Art Collection Unit  
 Badanami Centre for Indigenous Education  
 National Institute of Complementary Medicine  
 Dean's Unit - College of Health & Science
- Building 4**  
 Lecture Theatres  
 Lecture Rooms
- Building 5**  
 Centre for Complementary Medicine (Research)  
 Conference Room  
 Student Central  
 UWS International
- Building 6**  
 Bobbies Cafe  
 Information Technology Services
- Building 7**  
 School of Nursing and Midwifery
- Building 8**  
 School of Biomedical and Health Sciences
- Building 9**  
 Lecture Theatre
- Building 10**  
 Lecture Rooms
- Building 11**  
 School of Accounting  
 School of Economics and Finance  
 School of Management
- Building 12**  
 General Purpose Computer Labs  
 Information Technology Services
- Building 15**  
 School of Nursing and Midwifery
- Building 16**  
 Counselling and Disability Services  
 Equity and Diversity
- Building 17**  
 Family and Community Health (Research)  
 Nanoscale Organisation and Dynamics (Research)  
 School of Biomedical and Health Sciences  
 Solar Energy Technologies Group (Research)
- Building 18**  
 Centre for Complementary Medicine (Research)  
 School of Biomedical and Health Sciences
- Building 19**  
 Childcare Centre
- Building 20**  
 School of Biomedical and Health Sciences
- Building 21**  
 Campus Safety & Security  
 Capital Works & Facilities  
 Centre for Complementary Medicine (Research)  
 First Aid
- Building 21 (continued)**  
 Community and Public Sector Union  
 Lecture Theatres  
 Lecture Rooms  
 School of Biomedical and Health Sciences  
 Student Learning Unit
- Building 22**  
 School of Law
- Building 23 - Blocks 1 to 12**  
 Student Residences
- Building 24**  
 School of Biomedical and Health Sciences  
 Uniclinc
- Building 26**  
 School of Computing and Mathematics  
 School of Nursing and Midwifery
- Building 27**  
 Connect Fitness Centre
- Building 29**  
 Observatory
- Building 30**  
 School of Medicine
- DEM02**  
 Uniclinc
- DEM04**  
 Ride It Right

## Legend

- Shuttle Bus Route
- Bike Rack
- Bus Stop
- Campus Safety & Security
- First Aid
- Parking Bay
- Parking Permit Machine
- Accessible Parking
- Accessible Toilet
- Accessible Routes
- Stair Lift (Contact Security)
- Safety Routes
- NRMA Point
- Cafeteria
- Baby Changing Room
- Emergency Telephone